

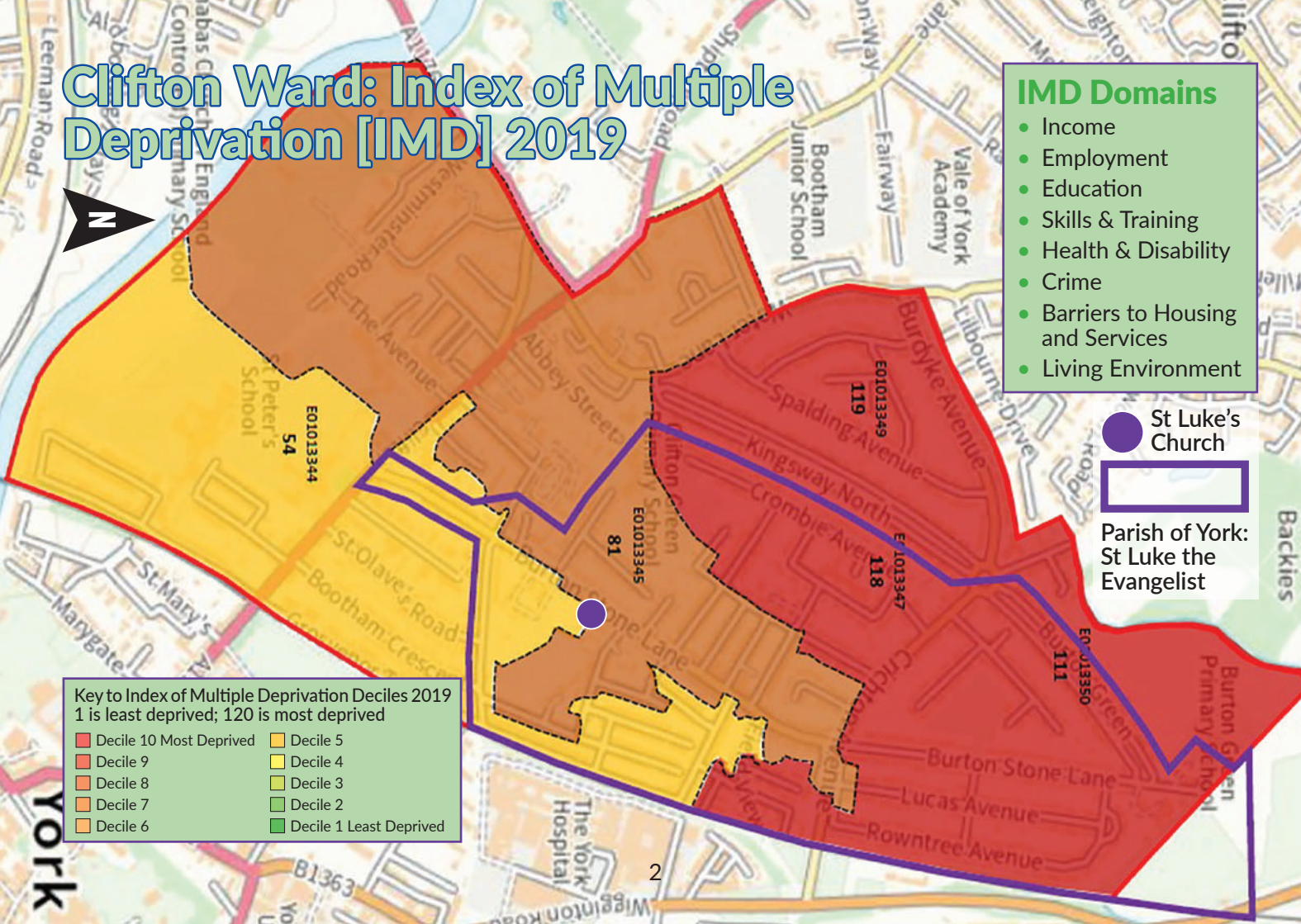

PRAYING · CARING · SHARING

Clifton Ward: Index of Multiple Deprivation [IMD] 2019



St Luke's is a church congregation in York with a big heart.

Our Parish lies on and around Burton Stone Lane to the north of the City Centre, and is located centrally within a Council Ward which is the second most deprived in the City.*

The populated part of the Parish is wholly contained within the Clifton Ward, and includes some of the worst areas of deprivation. Other poor areas lie close by.

*City of York Council: Clifton Ward Profile 2023/24



We want to be a community that opens doors...

We have:

A heart for those in need

- Luke's Larder waste food distribution project
- Part of the FareShare Yorkshire Community
- Provide food for up to 135 people weekly including refugees, homeless, children and young people

A heart for those on the outside

- Registered Inclusive Church
- Welcome to all – no ifs, no buts
- Extend a special welcome to LGBTQIA+ people
- Leadership of Christians at Pride in York

A heart for people who are socially isolated

- Weekly Joyful Connections Community Café
- Monthly Fairtrade Coffee Morning
- Tuesday Club
- Weekly Parent & Toddler group
- Monthly Forget me Not service for people with dementia and their families

A heart for our planet

- Pioneering Eco Church within the Diocese
- A Rocha Silver Award
- Striving towards A Rocha Gold award
- Aim to live simply, responsibly and sustainably
- Fairtrade Church

A heart for our community

- Aligned with City of York Council priorities for the Clifton Ward



St Luke's Community Hub Project

Buildings aren't everything, but we came to the stark realisation a few years ago that our buildings are a massive barrier to us being the church community we aspire to be – in the community, for the community.

Our 125th Anniversary in 2025 gives us a great opportunity to celebrate and to look forward to a new chapter.

The St Luke's Community Hub project enables us to open doors for our community.

The project achieved full Planning Consent in 2021.

Angela came to our Christmas Fair in 2024: 'Thank you for being you'

Mike attends Luke's Larder: 'Thank you guys for all your help since I moved to the area'

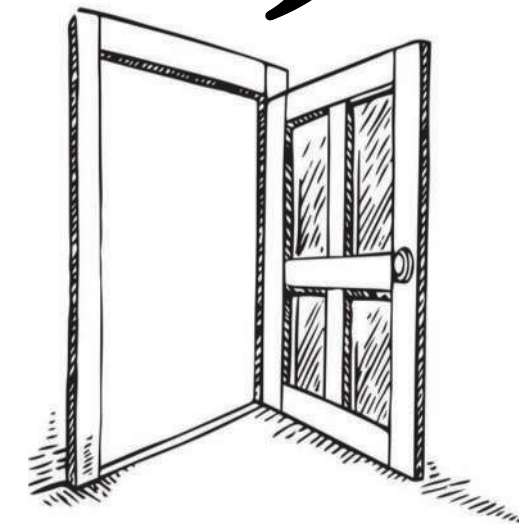

What St Luke's Community Hub project will bring...

Alice has used the Hall for birthday parties: 'An improved Community Hub would help build a sense of pride in the neighbourhood'

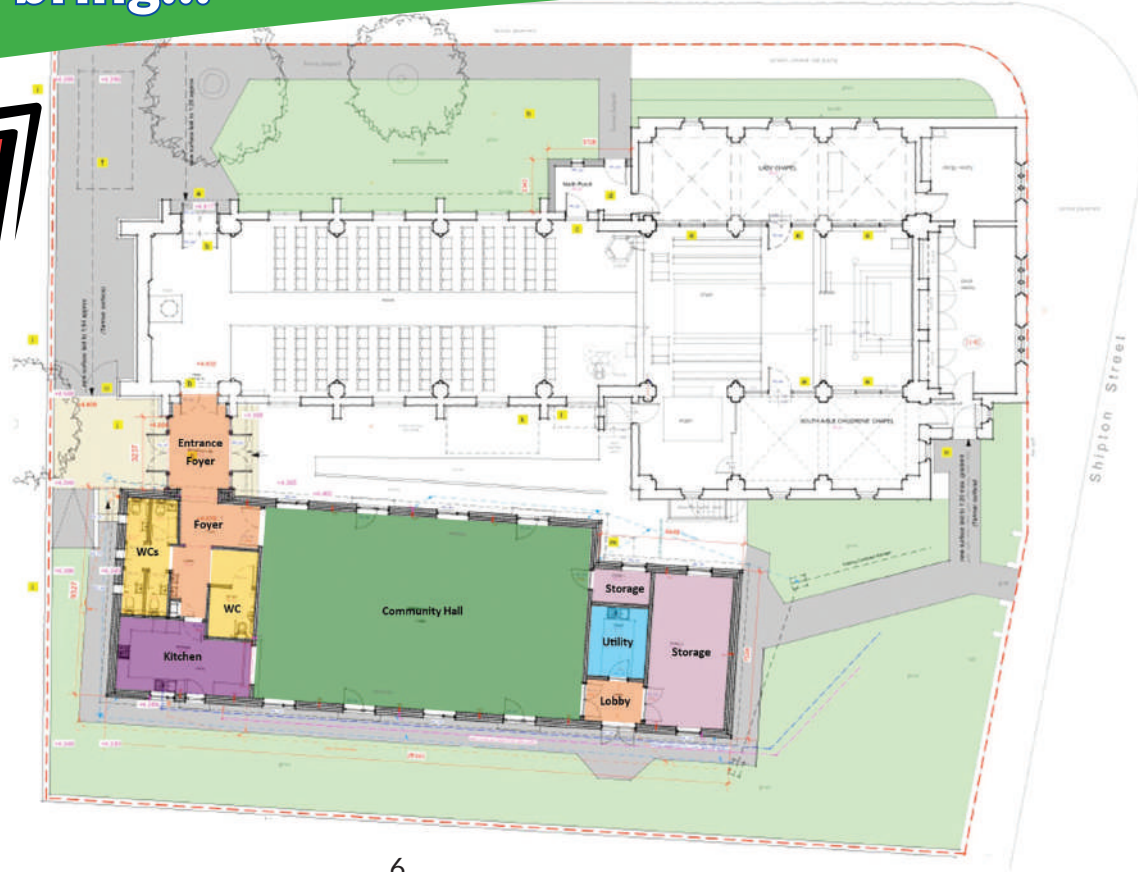

6

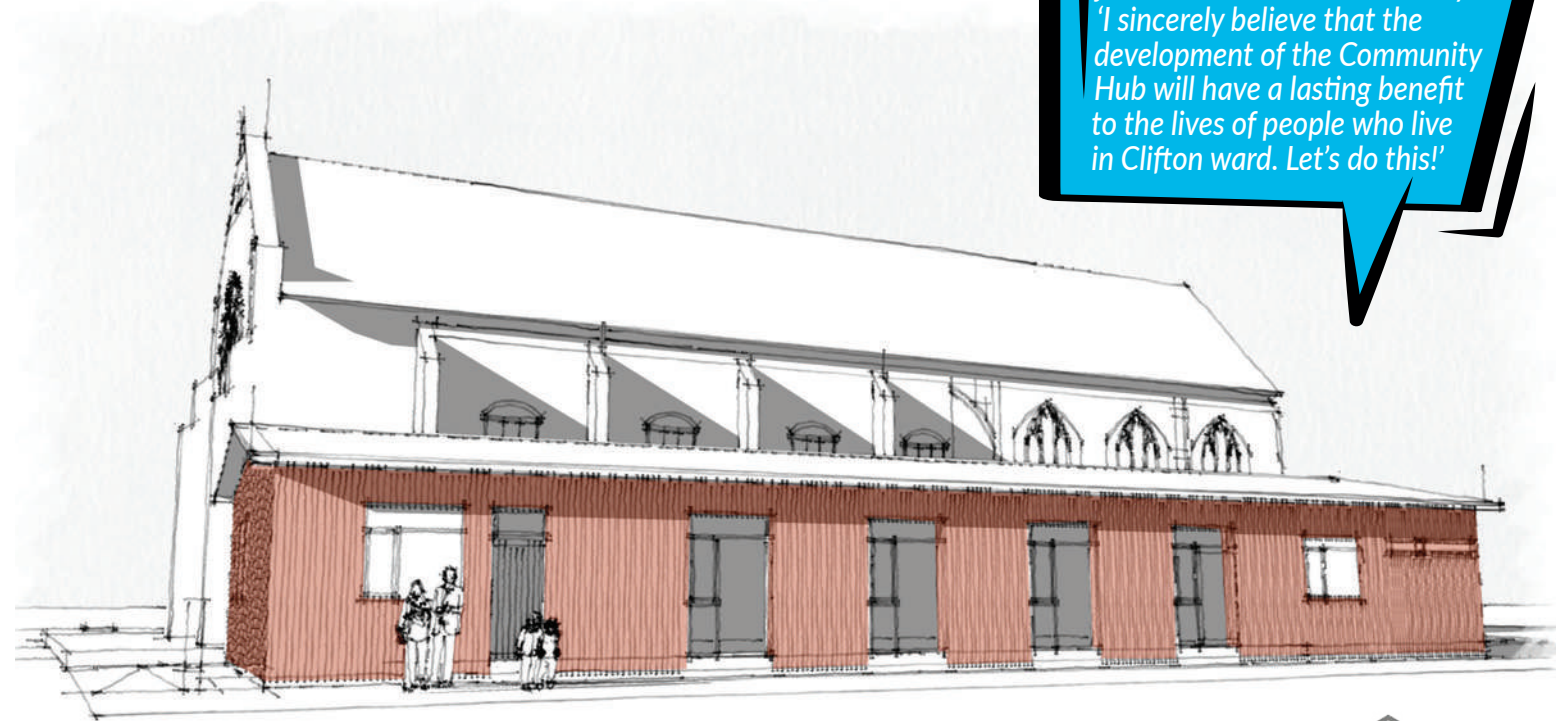

Josh recently joined St Luke's with his family: 'I sincerely believe that the development of the Community Hub will have a lasting benefit to the lives of people who live in Clifton ward. Let's do this!'



7

Without St Luke's Community Hub

Every entrance to the church and hall buildings has steps and there is no physical connection between buildings. The toilets and kitchen are located in the hall involving a journey outside for people in the church to access them

Toilet facilities are unattractive and difficult to keep clean and the so-called accessible toilet is a standard larger cubicle with some ad-hoc aids

Shabby and decaying premises hinder welcome by hiding the vibrant life of St Luke's

Lack of insulation in existing hall building is hugely wasteful and environmentally damaging

Use of fossil fuels for heating

Water ingress and decaying woodwork require increasingly costly maintenance

Activities risk closure through building breakdown

No Audio Visual facilities in hall building

Poor kitchen facilities where fresh food cannot be prepared or cooked

A pioneering Eco Church with an A Rocha Silver award will be unable to progress to Gold

With St Luke's Community Hub

Step free access into, within and between our buildings opens doors to **wheelchair** users and people with **limited mobility**

Fully **accessible, gender neutral** toilet provision opens doors for people who are **wheelchair** users, have **limited mobility** or are **transgender/non-binary**

A **modern**, pleasant, looked-after space with good facilities and a very **low carbon footprint** opens doors for people to use and enjoy it, making the facilities available for a broader section of the community and with a broader range of activities. This is particularly true for **youth work** which is one of our priorities

A comprehensive Audio Visual installation in all spaces opens doors for people who are **hard of hearing, neurodivergent, dyslexic** and those who are **housebound**

A catering standard kitchen enables us to prepare, cook and serve waste food and offer cooking classes, opening doors for people to make their own low cost healthy meals

An A Rocha Gold award will be possible

How might we accomplish this?

St Luke's Community Hub is a modest project that will bring massive benefits to the community and to the church and will transform what St Luke's is able to contribute to our community.

Phase 1: Cost £120,000 – Completed Spring 2022

- Level access entrances to Church building with new main entrance doors
- New porch and level access between Nave and Lady Chapel
- Glazed infill to arches between Chancel and side chapels giving independent meeting spaces



Phase 2: Cost £760,500

- Demolish and rebuild the hall including a new secure physical entrance link to the church building extending the existing footprint of the hall by about 4.3 metres creating:
 - Accessible toilets
 - Catering standard kitchen
 - New Community Hall space and storage
- Renewable energy heating and power
- Integrated Audio Visual systems in both buildings to improve accessibility
- Associated external landscaping including a dropped kerb/parking space on the Burton Stone Lane frontage for a funeral hearse/blue badge parking

'Clear, hold, build' in Clifton

Anna Harrison, the City of York Council Local Area Co-ordinator for the Clifton Ward, says:

The Home Office initiative '**Clear, Hold, Build**' has been operating in Clifton since March 2024. The three stage program aims to "**clear**" the community of serious and organised crime as well as tackling anti-social behaviour. The "**hold**" phase intends to ensure that other criminals do not step into the gap left by those who have been cleared from the area and "**build**" pulls in local residents as well as statutory and voluntary organisations to ensure that Clifton continues to be a safe and enjoyable place to live.

The "Build" phase very much relies on local resources to meet the needs of the Community. Currently there is a shortage of community assets that can be used to further this work. This Community Hub development at St Luke's would provide the people of Clifton with a modern, safe, flexible and welcoming space where the Church can continue their vital work tackling poverty and social isolation and other organisations can be brought in. These organisations would be able to further the work of the Church itself by providing services to tackle health inequalities and issues around mental health and addiction as well as Adult Education and Training.



From our Ward Councillors...



The Rt Hon Lord Mayor of York
Councillor Margaret Wells

St Luke's is known across our community as a church that cares and makes a difference. With Luke's Larder, Joyful Connections and other activities the church organises, they do much to enhance the lives of our residents.

We know that they want to do more, but are restricted by their limited facilities, with an ageing wooden hall building which is loved and cared for, but is no longer fit for purpose.

The priorities that we have set for our Ward through consultation with our residents reflect the very things that we know are important to St Luke's, so we feel a real sense of partnership with the church in what we are doing to try and make lives better for those in our community.

The new Community Hub building, together with the willing and enthusiastic volunteers from St Luke's and other organisations, will be able to open many more doors for our residents. This comes at a critical time when there is a major police led, multi-agency initiative in Clifton, 'Clear Hold Build', moving towards the 'build' point where we want to improve the living, working and recreational environment in the community for our residents. This stage of the initiative empowers them to work with stakeholders to generate resilience and build a safer community. We see the St Luke's Community Hub project as being essential to enabling this to happen.



Councillor Danny Myers



Rachael Maskell MP

From our MP...

St Luke's is a fantastic local hub, at the heart of the community.

It's an asset for people to attend events and connect with each other and the neighbourhood. I'm really supportive of the work to improve the facilities and ensure St Luke's continues to provide a welcoming space for all to use and enjoy.

From Brian, a resident of Clifton...

I try to get to Joyful Connections every week. I enjoy having a cuppa, playing some games and having a chat.

It gets me out on a Friday and gives me someone to talk to instead of being stuck on my own in four walls. It's a very friendly group and I feel welcome there.



Our Ward Priorities

- Enriching activities for health and well-being
- Improving opportunities and facilities for young people
- A greener, cleaner Clifton
- Engagement with residents for a more cohesive Clifton
- Reducing social isolation for a more inclusive Clifton



What we've achieved so far...

Phase 1 was completed in 2022



Step free entrance to North West Door



Step free passage to Lady Chapel through new porch

Glazed infill to Chancel Arches enabling independent use of the side chapels as meeting spaces

What do we need?

We believe that God has called us to this project in order to serve and work with our local community.

St Luke's already has c.£300,000 available to commit to the project and we are continuing to raise funds ourselves to close the gap, aiming to raise a minimum of 10% of the remaining £460,500.

However, without further funding, we will not be able to make this vision a reality.



A word from Revd Anika Gardiner, our Vicar...



The St Luke's Community Hub is so much more than a building project. Yes, updating the old hall is important but more so is creating a hub, connecting people and creating a safe, accessible space for young and old alike within our community.

Having a youth work background myself, it would be fantastic to be part of creating more opportunities for young people and families in our area, strengthening the links with our local schools and offering a space for people to get together. This hub will be a space of welcome, allowing people to try out new activities, develop skills and build up relationships within the church and the local community.

If you would like to, please join us in prayer.

A Prayer for the St Luke's Community Hub Project

Lord, you have entrusted the resources of the earth to our care and provide us with places to meet together as your people.

We ask for your blessing as we seek to make this project a reality for our Church and Community.

Be with all who will take part in bringing the plans for the new building to fruition. Give them wisdom, energy, strength and peace for the many tasks that need to be fulfilled, so that all who come to use St Luke's Community Hub may be filled with the love and joy of your presence.

We ask this prayer in the name of Jesus Christ, the cornerstone of our lives.

Amen





The Parochial Church Council of the Parish of St Luke, York is a Registered Charity – Number 1185606